

- [About](#)
- [Advertise](#)
- [Contact Us](#)
- [COMPETITIONS](#)
- [Submit Project](#)
- [Submit Job](#)



## [Midtown Manhattan Skygarden | New York USA | HM White](#)

By Damian Holmes on March 7, 2013



Redefining the 17th floor of the historic Western Publishing Building in midtown Manhattan, HM White has created a contemporary green roof garden terrace as an extension of Shorenstein Properties' new corporate offices. The 6,500 square-foot living roof establishes a biophilic transformation of the office environment and daily employee experience. A lush, sculpted garden wraps the building and visually merges interior office spaces with a serene meadow landscape, layered in contrast to its dense urban context.

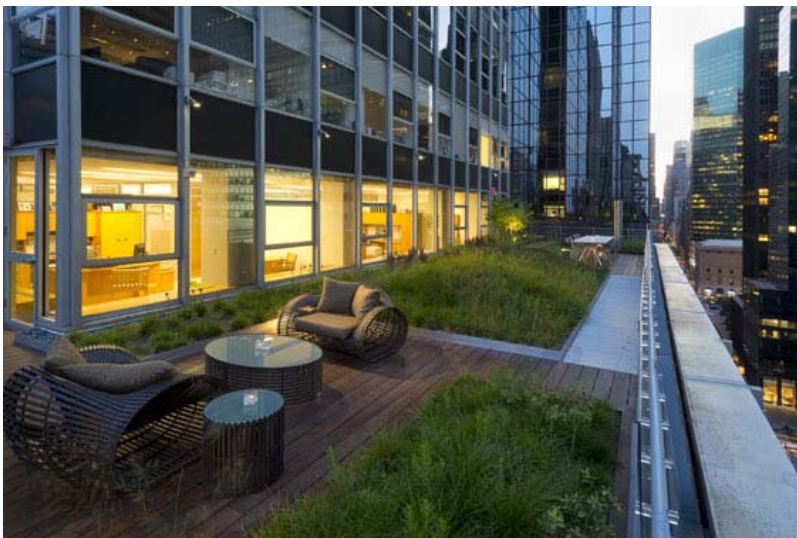

The garden terrace design unifies the building's roof with its restrained architectural geometries while expressing the planted surface as a rolling topographic relief. The vegetated landform is manipulated to accentuate depth of view from interior spaces through the landscape and highlight its undulating horizon against the city skyline.





The entire garden is carefully engineered to knit with building infrastructure to prevent potential wind uplift, accommodate significant weight restrictions and support a sophisticated, multi-seasonal plant palette tolerant of extreme growing conditions.



Comprised of native and regionally adapted plants, the elongated meadow design accentuates the sculpted surface with braided collections of drought tolerant grasses, perennials and spring bulbs—punctuated by flowering trees in structurally specific locations. The garden composition weaves seasonal colors and textures providing a dynamic tapestry with year-round visual interest.



Search

Subscribe to the WLA Newsletter

Name:

Email:

Subscribe

We respect your [email privacy](#)



## JOBS



[ADD YOUR JOB LISTING](#)

[LAND Reader](#)

## NEWS CATEGORIES

- [2012 In Review](#)
- [DESIGN AREAS](#)
  - [Architecture](#)
  - [Engineering](#)
  - [Landscape](#)
  - [Urban Planning](#)
- [GENERAL](#)
  - [Art](#)
  - [Design](#)
  - [Economics](#)
  - [Environment](#)
  - [Government](#)
  - [Horticulture](#)
  - [Infrastructure](#)
  - [Sustainable Design](#)
  - [Technology](#)
  - [Transport](#)
- [GEOGRAPHIC REGION](#)
  - [Africa](#)
  - [Asia](#)
  - [Central America](#)
  - [Europe](#)
  - [Middle East](#)
  - [North America](#)
  - [Oceania](#)
  - [South America](#)
- [RESOURCES](#)
  - [Blogs](#)
  - [Books](#)
  - [Business](#)
  - [Competition](#)
  - [Education](#)
  - [Employment](#)



## BOOK REVIEWS

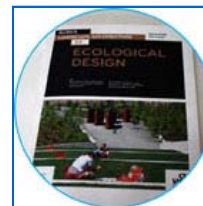





The office interior links with the exterior via a series of wooden platforms embedded in the landscape creating flexible “break-out” meeting spaces and places of respite perched 186 feet above the street. The intimate garden rooms connect with a perimeter path system framed by a translucent wind protection screen along the building’s edge. On the northwestern side of the building, linking with an employee break room, an isolated roof space is transformed into an outdoor golf putting green providing a whimsical gaming retreat instantly popular with staff.

Establishing a sustainable retrofit of the 1962 Emory Roth & Sons building design, HM White synthesizes strict structural limitations and budgetary restraints with state of the art green roof technology and horticultural practices.

**Landscape Architect** | [HM White](#)

**Architect** | [Gertler & Wentz Architects](#)

**Structural Engineer** | [Urban Tech](#)

**MEP** | [AKF Engineers](#)

**Lighting Designer** | [Atelier Lumiere](#)

**Landscape Contractor** | [New York Green Roofs](#)

**Photographer** | C. Taylor Crothers Photography

4

Tags: [city skyline](#), [drought tolerant grasses](#), [employee experience](#), [flowering trees](#), [interior office](#), [midtown manhattan](#), [northwestern side](#), [outdoor golf](#), [path system](#), [roof space](#), [seasonal colors](#), [seasonal plant](#), [spaces and places](#), [spring bulbs](#), [topographic relief](#), [weight restrictions](#), [western publishing](#), [wind protection](#), [wind uplift](#), [wooden platforms](#)  
 Posted in [Architecture](#), [Horticulture](#), [Landscape](#), [North America](#), [Sustainable Design](#) | [1 Comment »](#)

**One Response to “Midtown Manhattan Skygarden | New York USA | HM White”**

- 
[SimtenSutunc](#)  
[March 7, 2013, CST at 9:14 pm](#)



- [Event](#)
  - [Videos](#)
- [This Week in Landscape](#)
- [urban](#)
- [VIDEO](#)

RT @wlandscapearch: Midtown Manhattan Skygarden | New York USA | HM White: <http://t.co/YESuR6WKBj> #NYC #greenroof #relax

## Leave a Reply

You must be [logged in](#) to post a comment.

« [HASSELL to design high street public realm proposals for Croydon Council](#)

## Translator



[SUBMIT PROJECT](#)

[SUBMIT EVENT](#)

[SUBSCRIBE TO WEEKLY NEWSLETTER](#)

[SUBSCRIBE DAILY UPDATES](#)

[FOLLOW US ON TWITTER](#)

[BECOME A FAN ON FACEBOOK](#)

[JOIN US ON LINKEDIN](#)

[ABOUT](#)

[ADVERTISE](#)

[CONTACT WORLD LANDSCAPE](#)

[ARCHITECTURE TO BECOME A](#)

[SPONSOR/PARTNER](#)

[DISCLAIMER](#)

[PRIVACY POLICY](#)

OPTIMISED FOR MOBILE

All Rights Reserved - Copyright © 2007-2012 [World Landscape Architecture – landscape architecture webzine](#)

0

## SPONSORS & PARTNERS

